

*\* 2 Bedrooms / 2 Baths*

*1095 sq. feet*

*From \$ \_\_\_\_\_ per month*

*\* Approximate Square Footage*

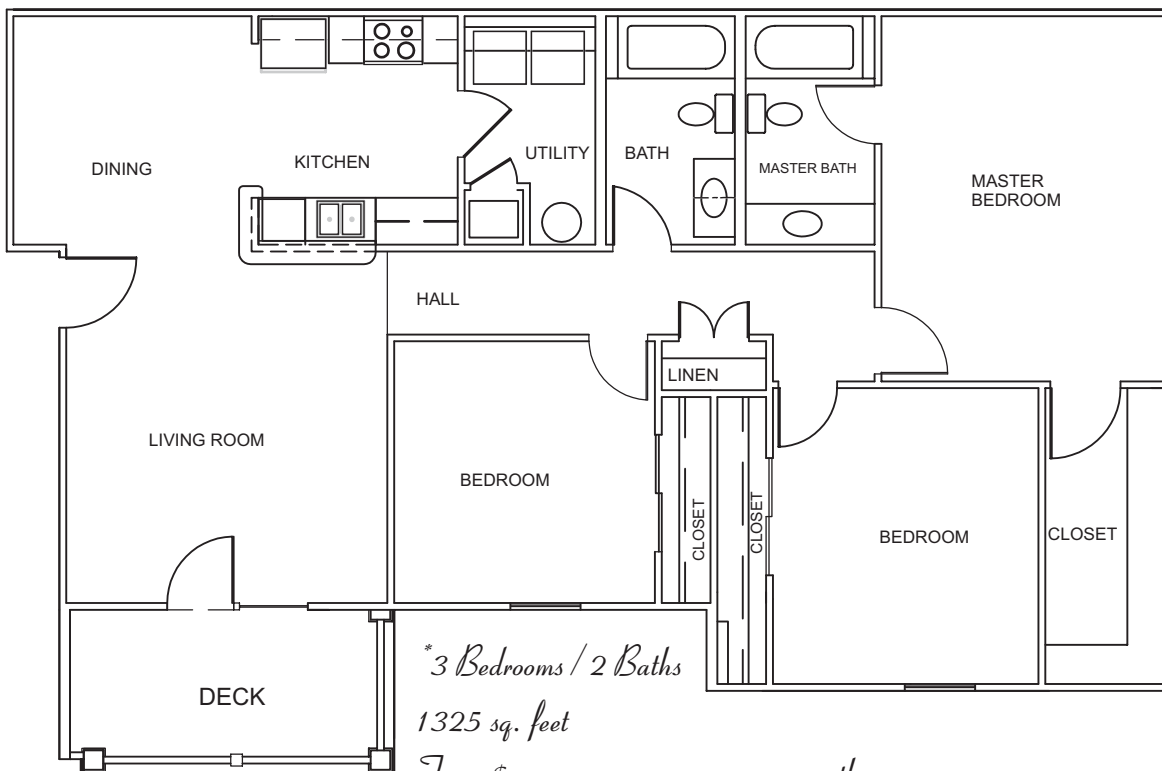

*\* 3 Bedrooms / 2 Baths*

*1325 sq. feet*

*From \$ \_\_\_\_\_ per month*

*\* Approximate Square Footage*

# *Ashton Mill Apartment Homes*

## *Nicely Appointed Apartment Homes*

- |   |   |
|---|---|
| <input type="checkbox"/> Water View Available             | <input type="checkbox"/> Crown Moulding         |
| <input type="checkbox"/> Central Location                 | <input type="checkbox"/> Breakfast Bar          |
| <input type="checkbox"/> Brick and Cement Board Exteriors | <input type="checkbox"/> Patio/Balconies        |
| <input type="checkbox"/> 9 Ft. Ceilings                   | <input type="checkbox"/> Controlled Access Gate |
| <input type="checkbox"/> 3 rd. Floor Vaulted Ceilings     | <input type="checkbox"/> Cardio Workout Room    |
| <input type="checkbox"/> Gourmet Kitchens                 | <input type="checkbox"/> Swimming Pool          |
| <input type="checkbox"/> Washer/Dryer Connections         | <input type="checkbox"/> Energy Efficient       |
| <input type="checkbox"/> French Doors                     | <input type="checkbox"/> Small Pets Conditional |